

**SETA HEAD START CLASSROOM BUILDING  
AND SITE IMPROVEMENTS**

**ADDENDUM #1**

Date: Tuesday, May 8, 2018

Owner: SETA Head Start  
925 Del Paso Blvd, Suite 100  
Sacramento, CA 95815

Architect: Williams + Paddon Architects  
2237 Douglas Blvd., Suite 160  
Roseville, CA 95661

---

**Greg M. Tonello – C18650, Exp. 02/28/19**

This Addendum has been prepared to clarify, modify, delete, or add to the drawings and/or specifications for the above referenced project, and revisions to items listed here shall supersede description thereof prior to the above stated date. All conditions not specifically referenced here shall remain the same. It is the obligation of the Prime Contractor to make subcontractors aware of any items herein that may affect submitted bids.

In case of conflict between the bid documents and this Addendum, this Addendum shall govern. This Addendum shall be considered part of the Plans, Specifications, and Contract Documents. All addenda items refer to the plans and project manual(s) unless specifically noted otherwise.

Acknowledge receipt of this addendum by inserting its number and date on the BID FORM at time of bid. Failure to do so may subject bidder to disqualification.

TOTAL PAGES IN THIS ADDENDUM (excluding attachments): 4

**I. GENERAL ITEMS:**

- A. Enclosed herein is a copy of the mandatory pre-bid walk sign-in sheet held on May 2, 2018 at the project site.
- B. Enclosed herein is a copy of the American Modular Systems schedule.
- C. The encroachment permit for new parking lot driveway cut and for the storm drain tie-in at street will be submitted, paid for, and pulled by the civil engineer. The site general contractor will be responsible for performing the work and coordinating inspections with the City of Sacramento. Site contractor will also need to provide traffic control plans and proof of insurance.

**II. CHANGES TO DRAWINGS:**

**A. DRAWING SHEET(S):**

**1. SHEET AND TITLE: C2.0 DEMOLITION PLAN**

- a. The following items (referenced by demolition keynotes 5, 6, 7, and 13) will be demolished and removed from the site by OWNER.
- b. The existing portable building and foundations (referenced by demolition keynote 4) will be moved off the site by OWNER.
- c. Demolition keynote #10 shall read 'DEMOLISH EXISTING TRASH ENCLOSURE CONCRETE CURB'.
- d. Demolition keynote #12 shall read 'CAREFULLY REMOVE EXISTING IRRIGATION CONTROL VALVE, RELOCATE AWAY FROM BUILDING FOR A COMPLETE WORKING SYSTEM.
- e. The single tree to be demolished as part of this project (referenced with demolition keynote 1) requires a public notice be posted to the community before removal. The posting was placed by City of Sacramento officials on May 3, 2018. Barring any objection, the tree may be removed on or after May 19, 2018.

**2. SHEET AND TITLE: C3.0 GRADING AND UTILITY PLAN**

- a. Add a concrete curb around the new parking lot as part of alternate #1, see clouded revision below:

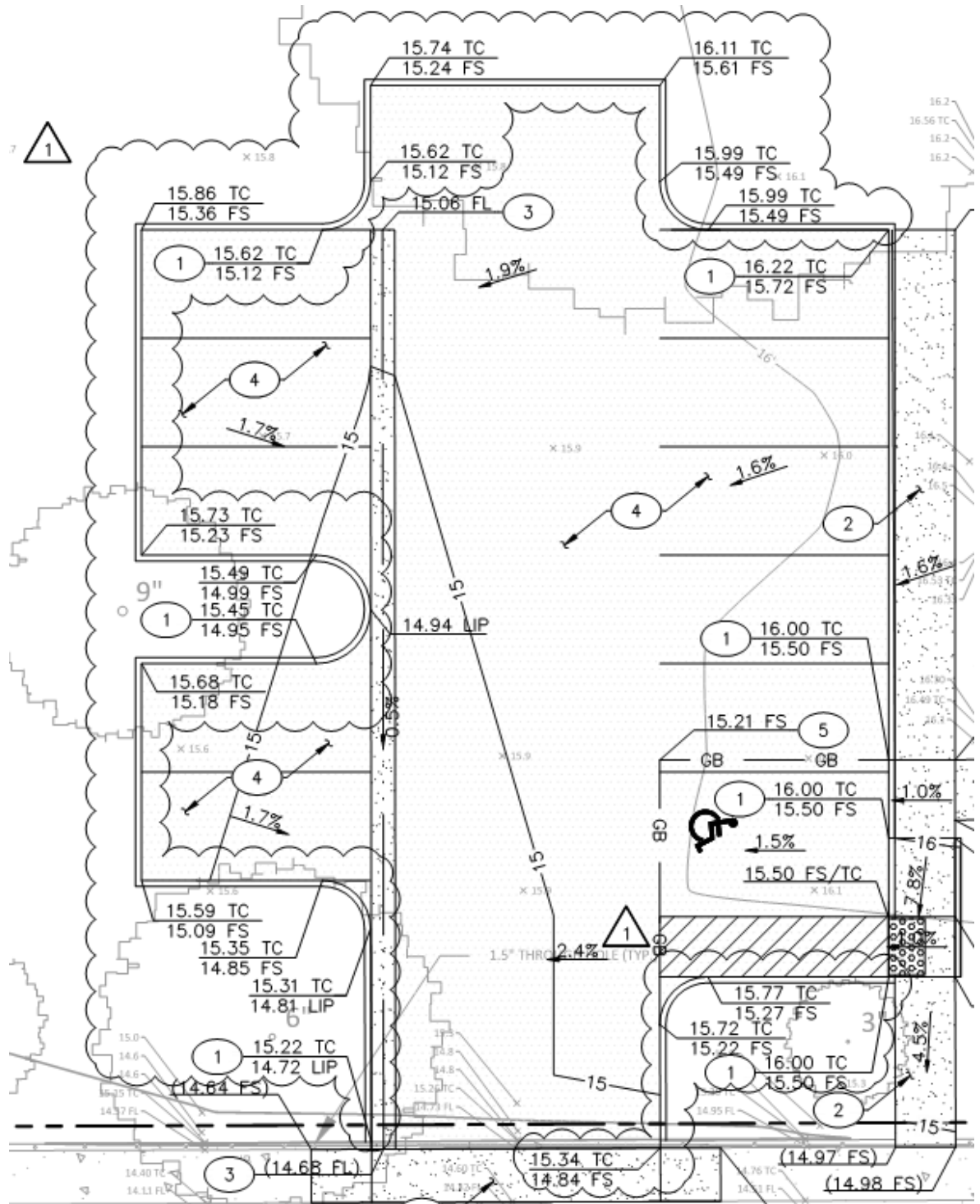

**3. SHEET AND TITLE: A1.2.1 SITE DETAIL – FENCING**

- a. All new chain link fencing in project shall be 6'-0" high.

**III. CHANGES TO SPECIFICATIONS:**

**A. SPECIFICATION(S)**

**1. SECTION 10 14 00 – SIGNAGE**

- a. Add entire section (all code related signage on project by site contractor).

**END OF ADDENDUM**



American Modular Systems  
1433-17 Seta Modular project

ID	Task Name	Duration	Start	Finish	Predecessors	'18							'18							
						T	W	T	F	S	S	M	T	W	T	F	S	S	M	T
1	progress set due		Thu 4/5/18																	
2	agency submittal		Tue 4/17/18																	
3	permit approval		Thu 5/31/18																	
4	<b>Demo complete (by others)</b>	<b>1 day</b>	<b>Fri 6/1/18</b>	<b>Fri 6/1/18</b>																
5	<b>site preparation (by others)</b>	<b>12 days</b>	<b>Fri 6/1/18</b>	<b>Tue 6/19/18 4</b>																
6	<b>Production 84x40</b>	<b>26.88 days</b>	<b>Tue 5/8/18</b>	<b>Wed 6/13/18</b>																
14	<b>foundation</b>	<b>17 days</b>	<b>Tue 6/19/18</b>	<b>Wed 7/11/18</b>																
15	Lay out	1 day	Tue 6/19/18	Tue 6/19/18																
16	excavate	1 day	Wed 6/20/18	Wed 6/20/18	15															
17	set up forms	5 days	Thu 6/21/18	Wed 6/27/18	16															
18	install rebar	4 days	Thu 6/28/18	Tue 7/3/18	17															
19	pour	1 day	Wed 7/4/18	Wed 7/4/18	18															
20	strip forms	2 days	Fri 7/6/18	Mon 7/9/18	19FS+1 day															
21	cure	5 days	Thu 7/5/18	Wed 7/11/18	19															
22	install access well/vents	3 days	Tue 7/17/18	Thu 7/19/18	27															
23	<b>Delivery</b>	1 day	Tue 7/10/18	Tue 7/10/18	20,13															
24	<b>crane set</b>	1 day	Tue 7/10/18	Tue 7/10/18	20															
25	<b>Building set</b>	<b>14 days</b>	<b>Wed 7/11/18</b>	<b>Mon 7/30/18</b>																
26	bolt up	2 days	Wed 7/11/18	Thu 7/12/18	24															
27	flash exterior	2 days	Fri 7/13/18	Mon 7/16/18	26															
28	<b>interior cross overs</b>	<b>3 days</b>	<b>Fri 7/13/18</b>	<b>Tue 7/17/18</b>																
33	<b>Site work (by others)</b>	<b>10 days</b>	<b>Tue 7/17/18</b>	<b>Mon 7/30/18</b>																
34	<b>Utility connects</b>	<b>1 day</b>	<b>Tue 7/17/18</b>	<b>Tue 7/17/18 27</b>																
35	<b>Flat work installed</b>	<b>1 day</b>	<b>Fri 7/20/18</b>	<b>Fri 7/20/18 22</b>																
36	<b>low voltage installations</b>	<b>10 days</b>	<b>Tue 7/17/18</b>	<b>Mon 7/30/18 29</b>																
37	Substantial completion	1 day	Tue 7/31/18	Tue 7/31/18	36															

Project: SETA 042018 Date: Mon 5/7/18	Task		Inactive Task		Manual Summary Rollup		External Milestone	
	Split		Inactive Milestone		Manual Summary		Deadline	
	Milestone		Inactive Summary		Start-only		Progress	
	Summary		Manual Task		Finish-only		Manual Progress	
	Project Summary		Duration-only		External Tasks			